

LAZY SUSAN WITH THREE DRAWERS Base Cabinet ASSEMBLY INSTRUCTIONS

Step 1-

1. Place cabinet Right Back Panel (B) on a soft working surface with grooves facing upward, fit the Right Side Panel (A) together with the clips fully engaged. Insert locking screw into each clip pair and tighten all screws.
2. Repeat the Step 2.1 to assemble the Left Back panel (B) and Left Side Panel (A) together.

Step 2 -

1. Position Bottom a Panel (D) into the grooves on the Side Panels (A) and (B) and attach together with the clips fully engaged. Insert locking screw into each clip pair and tighten all screws. Fasten all the screws from the back of both Back Panels (B) to make (A) and (B) securely connected. Rotate unit upright.

Step 3 -

1. Attach Toe Kick Plates (J) to Front Side Panels (A) with the clips fully engaged. Insert locking screw into each clip pair and tighten all screws.
2. Position the two Front Frames (K) and (L) on the Front Side Panels (A), making sure panels fit into the grooves of the Front Frames (K) and (L) with the clips fully engaged. Insert locking screw into each clip pair and tighten all screws. Insert a long screw through pre-drilled holes in front face ends and tighten.

Step 4 -

1. Slide the Back Panel (H) against right/left side panels as shown, from the back of the cabinet insert screws into pre-drilled holes and tighten.
2. Position Strengthen Stile (N) into place and attach with screws
3. Secure spinner unit top to strengthen stile(N)

Step 5 -

1. Lay a Drawer Front Panel (M) on a soft working surface with grooves facing upward. The grooves will be for the Drawer Bottom Panel (F).
2. Insert the Drawer Side Panels (C) to the dovetail grooves on the Drawer Front Panel (M) with all the dovetails engaged until flush. Tap with a rubber mallet if necessary.
3. Slide the Drawer Bottom Panel (F), finished surface faces upward, into the grooves of the Drawer Side Panels (C) and the Drawer Front Panel (M).
4. Attach Drawer Back Panel (E) to Drawer Side Panels (C) with all the dovetails engaged until flush.
5. Attach Drawer Slide - Drawer Members (P), to Drawer Side Panels (C) through pre-drilled holes with screws and tighten.

Step 6 -

1. Install Drawer Slide - Cabinet Members (Q), by inserting the slide sockets barbed dowels into cabinet Back Panel (H) pre-drilled holes and use screws to attach the sockets to the Back Panel (H) through pre-drilled holes and tighten.
2. Attach Drawer Slide - Cabinet Members (Q), to cabinet Side Panels (A) through pre-drilled holes with screws and tighten.
3. Slide drawers into drawer guides through the front of the cabinet.
4. Repeat Steps 5 and 6 for additional drawers.

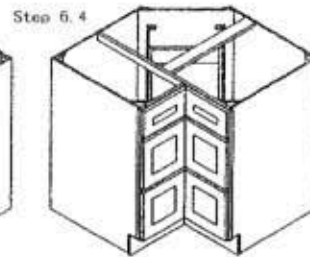
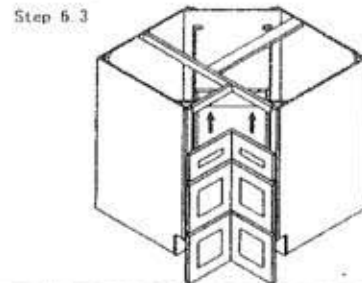
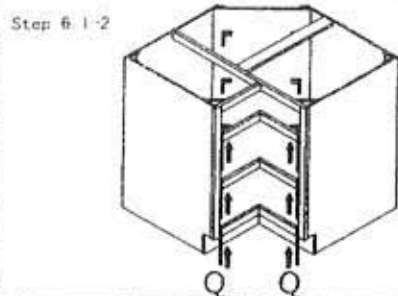
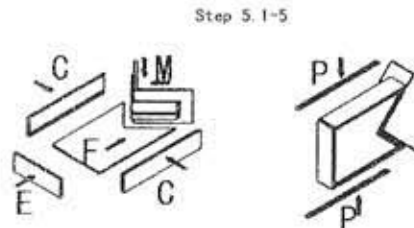
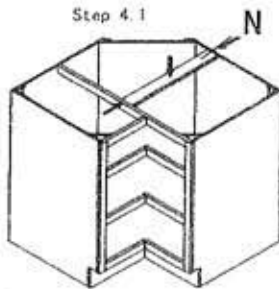
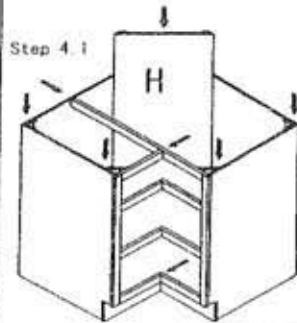
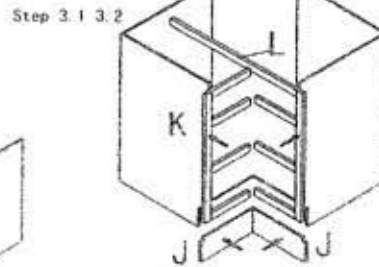
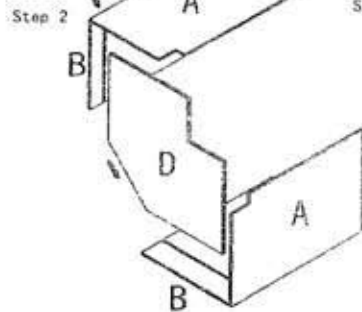
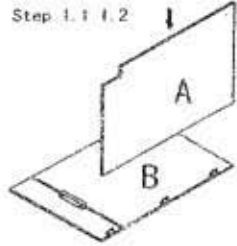

PARTS LIST:

	ITEM	QTY
A	RIGHT/LEFT SIDE PANEL	2
B	RIGHT/LEFT BACK SIDE PANEL	2
D	BOTTOM PANEL	1
H	BACK PANEL	1
K/L	FRONT FACE	2
J	TOE KICK PLATE	2
N	STRENGTHEN STILE	1
M	DRAWER FRONT PANEL	3
E	DRAWER BACK PANEL	3
C	DRAWER LEFT/RIGHT SIDE PANEL	6
F	DRAWER BOTTOM PANEL	3
Q	DRAWER SLIDW-CABINET MEMBER	6
P	DRAWER SLIDW-DRAWER MEMBER	6